

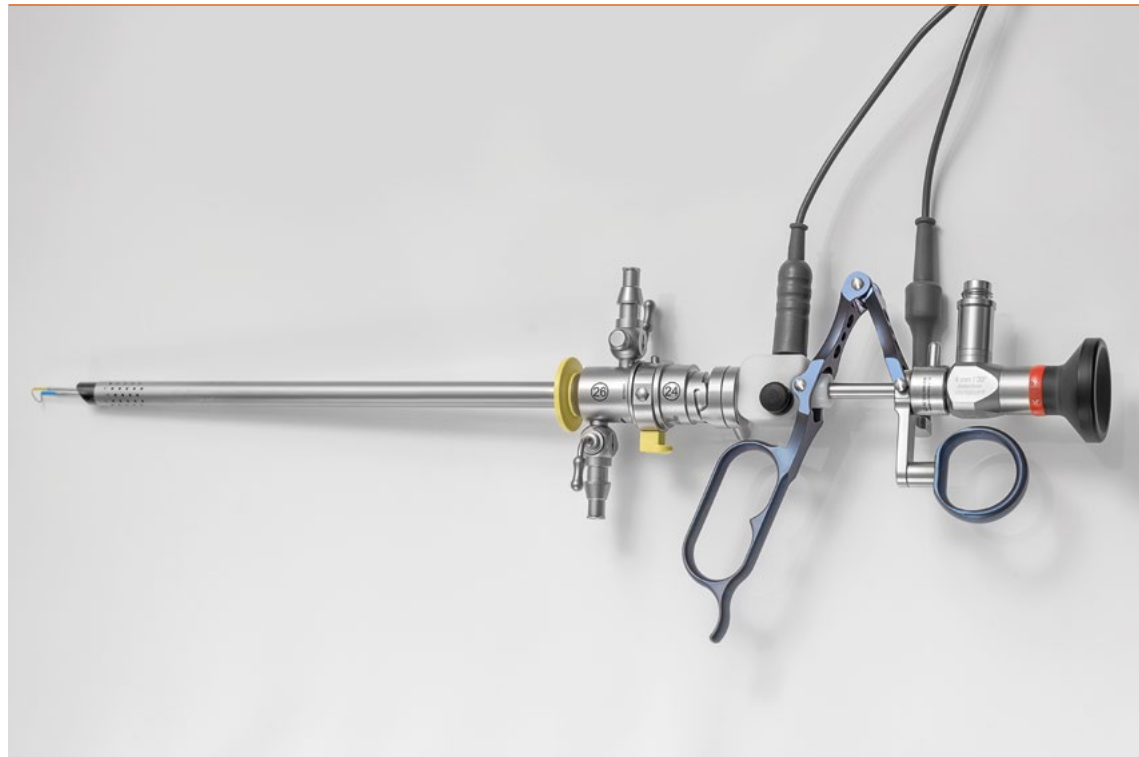

## HYBRID 26Charr. System

Bipolar and Monopolar  
26 Charr. Resectoscope



 ASSEMBLING / DISASSEMBLING

## 26 Charr. HYBRID SYSTEM

consisting of:

**1** RZ Cystoscope, 30°, Ø 2.9mm

**2** RZ Working Element, active or passive

**3** Electrode (monopolar or HYBRID)

**4** RZ 26 Charr. Continuous Flow Sheath with obturator

**5** Bipolar Cable / Monopolar Cable

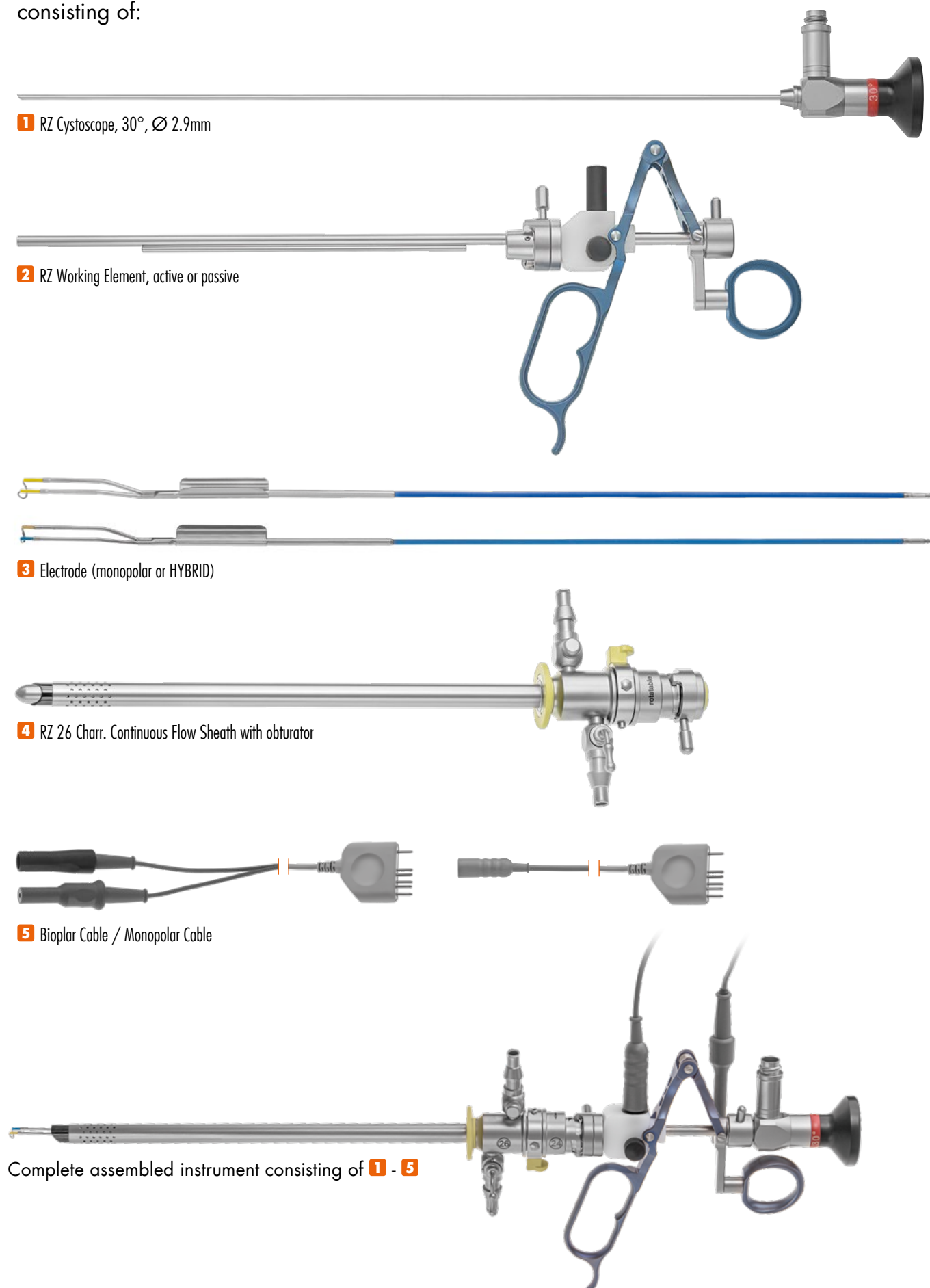

Complete assembled instrument consisting of **1** - **5**



### STEP 1

Prepare the electrode and the working element.  
This manual shows how to assemble the active working element. It is also intended for the passive working element.  
**NOTE:** please make sure to start with the correct electrode (monopolar/bipolar/HYBRID).

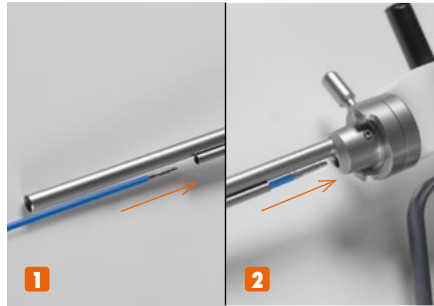

### STEP 2

- 1** Push the proximal end of the electrode into the guide tube of the working element.
- 2** Push the electrode completely through the guide tube until it reaches the electrode holder on the working element.

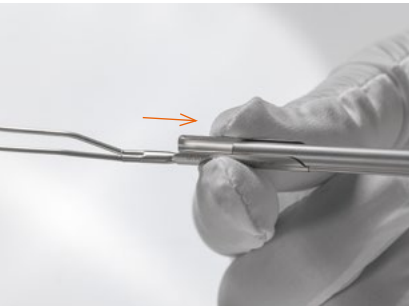

### STEP 3

Slide the guide rail of the electrode over the optics guide tube of the working element.

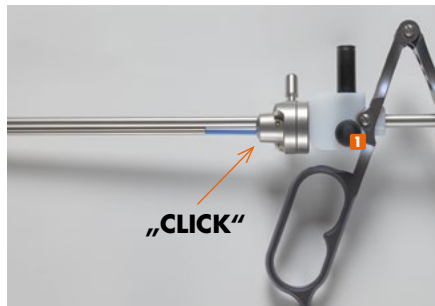

### STEP 4

The electrode must engage perceptibly, a „click“ sound can be heard.  
  
Caution: do not press the electrode release button **1** during this procedure!

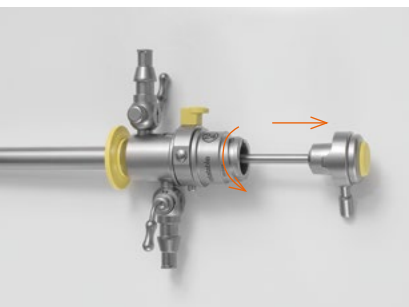

### STEP 5

Open the obturator lock and pull it completely out of the shaft.

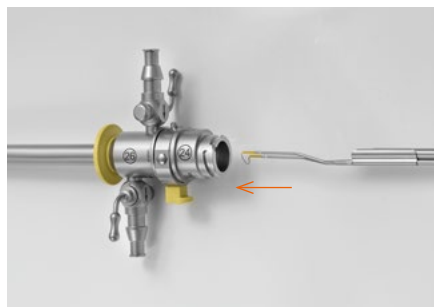

### STEP 6

Insert the working element with inserted electrode into the shaft.

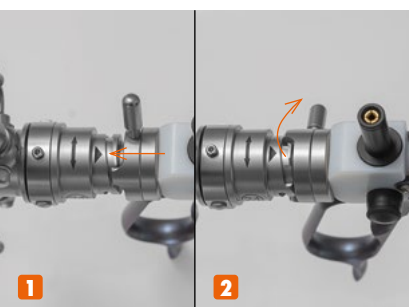

### STEP 7

- 1** Make sure that the nose of the fastener is attached to the guide.
- 2** Close the system with the lever by turning it clockwise.

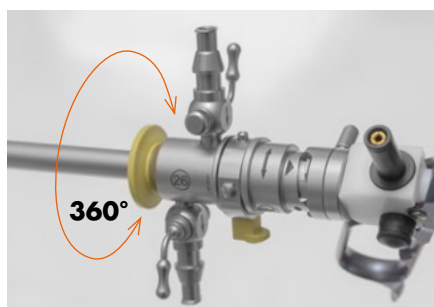

### STEP 8

Check that the shaft can be rotated 360°.  
The lock of the shaft and the working element must not rotate.



### STEP 9

Move the telescope lock to the „0“ position.  
Insert the endoscope into the system.



### STEP 10

Turn the lock clockwise to tighten the endoscope to the system.

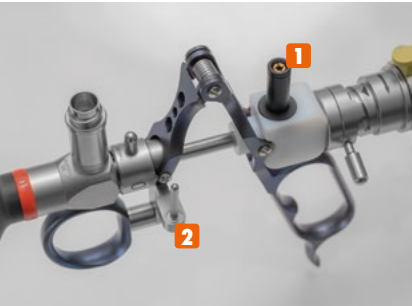

## STEP 10

To connect the correct HF Cable, the working element is fitted with two connectors:

**1** for monopolar cable

**2** for bipolar/HYBRID cable.

To work in bipolar/HYBRID mode, connect both with your corresponding cable.



## STEP 11

### MONOPOLAR MODE:

Connect the corresponding HF monopolar cable to **1**



## STEP 12

### BIPOPOLAR/HYBRID MODE:

Connect the corresponding HF HYBRID cable to **1** and **2**

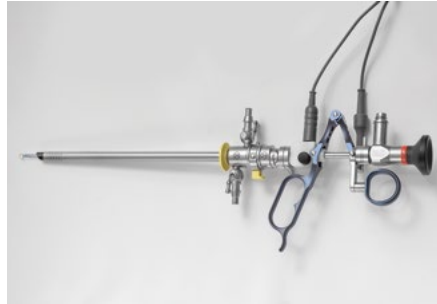

## DONE

The resectoscope is now completely assembled and ready to operate.



## STEP 1

Disconnect the HF cable.



## STEP 2

Switch the lever of the telescope connection back to „0“ position to open the lock.

Pull out the endoscope completely.

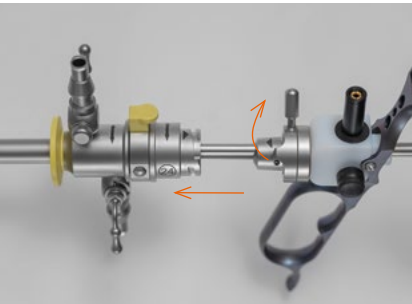

## STEP 3

Turn the lever of the working element counterclockwise to release the nose from the guide.

Pull out the shaft completely.

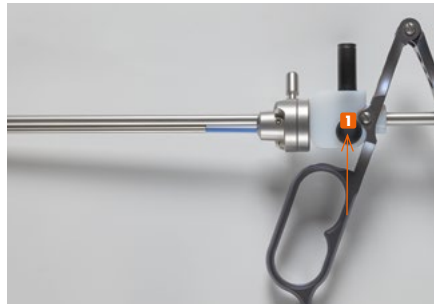

## STEP 4

Press and hold the electrode button 1 and keep it pressed.

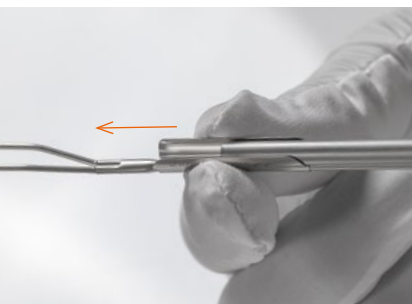

## STEP 5

Turn the lever of the working element counterclockwise to release the nose from the guide.

Pull out the shaft completely.

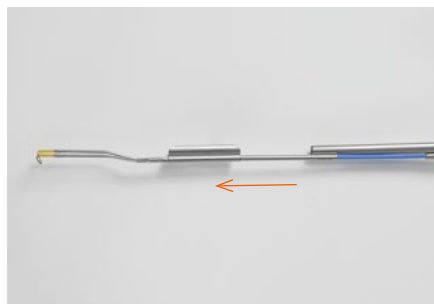

## STEP 6

Pull the electrode completely out of the guide tube.

Be careful not to bend the electrode during this process.



## DONE

The system is now completely detached.



## **RZ Medizintechnik GmbH**

Unter Hasslen 20 / 22  
78532 Tuttlingen, Germany

+49 7462 9470-0

[sales@rz-medizintechnik.com](mailto:sales@rz-medizintechnik.com)  
[www.rz-medizintechnik.com](http://www.rz-medizintechnik.com)